

## IE-C5DB4RE0015MCSMCA-E

**Weidmüller Interface GmbH & Co. KG**  
Klingenbergstraße 26  
D-32758 Detmold  
Germany

www.weidmueller.com



Assembled IE cables, railway cable, Cat.5, black, M12

### General ordering data

|            |  |
|------------|--|
| Version    | System cable, M12 D-code - IP 67 straight pin, M12 D-code - IP 67 angled pin, Cat.5 (ISO/IEC 11801) / Cat.5e (TIA T568-B), Radox GW S, 1.5 m |
| Order No.  | <a href="#">1059940015</a>   |
| Type       | IE-C5DB4RE0015MCSMCA-E   |
| GTIN (EAN) | 4032248808670  |
| Qty.       | 1 pc(s).   |

Creation date March 22, 2021 9:39:41 PM CET

Catalogue status 12.03.2021 / We reserve the right to make technical changes.

## IE-C5DB4RE0015MCSMCA-E

Weidmüller Interface GmbH &amp; Co. KG

Klingenbergstraße 26

D-32758 Detmold

Germany

www.weidmueller.com

## Technical data

## Dimensions and weights

|            |       |                 |             |
|------------|-------|-----------------|-------------|
| Length     | 1.5 m | Length (inches) | 59.055 inch |
| Net weight | 147 g |                 |             |

## Temperatures

|                          |                |                       |                |
|--------------------------|----------------|-----------------------|----------------|
| Storage temperature      | -40 °C...90 °C | Operating temperature | -40 °C...90 °C |
| Installation temperature | -25 °C...90 °C |                       |                |

## Environmental Product Compliance

|            |                |
|------------|----------------|
| REACH SVHC | Lead 7439-92-1 |
|------------|----------------|

## Cable specific standards

|                                  |   |  |   |
|----------------------------------|---|--|---|
| Corrosiveness of fumes           | to IEC 60754-2  | Fire protection in buses                         | According to ISO 6722-1<br>5.22 (UN ECE-R 118.01)                               |
| Fire safety for railway vehicles | According to DIN<br>5510-2 fire safety levels<br>1,2,3,4, According to<br>BS 6853, According to<br>EN50288-2-2, According<br>to EN 45545, HL1 - HL3 | Flames propagate vertically on bundled<br>cables | According to BS4066-3,<br>DIN EN 50266-2-5,<br>According to IEC<br>60332-3-25 D |
| Fluorine content                 | According to EN 60684-2<br>Section 45.2   | Hydrogen halide content                          | According to<br>EN-50267-2-1, According<br>to IEC 60754-1                       |
| Impervious to smoke              | According to BS 6853<br>Appendix D, in accordance<br>with EN 50268-2,<br>According to IEC 61034-2   | Multi-wire metallic data and control<br>cable    | According to<br>EN50288-2-2   |
| Poisonous gases                  | According to BS 6853<br>Appendix B  |  |   |

## General standards

|                         |         |                    |                 |
|-------------------------|---------|--------------------|-----------------|
| Certificate no. (cULus) | E316369 | Connector standard | IEC 61076-2-101 |
|-------------------------|---------|--------------------|-----------------|

## Standards

|                                  |   |  |   |
|----------------------------------|---|--|---|
| Connector standard               | IEC 61076-2-101   | Corrosiveness of fumes                           | to IEC 60754-2  |
| Fire safety for railway vehicles | According to DIN<br>5510-2 fire safety levels<br>1,2,3,4, According to<br>BS 6853, According to<br>EN50288-2-2, According<br>to EN 45545, HL1 - HL3 | Flames propagate vertically on bundled<br>cables | According to BS4066-3,<br>DIN EN 50266-2-5,<br>According to IEC<br>60332-3-25 D |
| Fluorine content                 | According to EN 60684-2<br>Section 45.2   | Hydrogen halide content                          | According to<br>EN-50267-2-1, According<br>to IEC 60754-1                       |
| Impervious to smoke              | According to BS 6853<br>Appendix D, in accordance<br>with EN 50268-2,<br>According to IEC 61034-2   | Multi-wire metallic data and control<br>cable    | According to<br>EN50288-2-2   |
| Poisonous gases                  | According to BS 6853<br>Appendix B  |  |   |

Creation date March 22, 2021 9:39:41 PM CET

Catalogue status 12.03.2021 / We reserve the right to make technical changes.

2

**IE-C5DB4RE0015MCSMCA-E**
**Weidmüller Interface GmbH & Co. KG**

Klingenbergstraße 26

D-32758 Detmold

Germany

www.weidmueller.com

**Technical data**
**Cable structure**

|                       |   |                          |         |
|-----------------------|---|--------------------------|---------|
| Cross-section         | 2*2*AWG 22/7 - 2*2*0.36 mm <sup>2</sup> | Insulation cross-section | 1.95 mm |
| Material sheath       | Radox GKW S                             | Sheath diameter, max.    | 7.55 mm |
| Sheath diameter, min. | 6.95 mm                                 | Sheathing colour         | black   |
| Shielding             | SF/UTP                                  | Strands                  | 7       |

**Electrical properties of cable**

|          |  |
|----------|--|
| Category | Cat.5 (ISO/IEC 11801) /<br>Cat.5e (TIA T568-B) |
|----------|--|

**Mechanical and material properties of cable**

|                                 |  |                        |  |
|---------------------------------|--|------------------------|--|
| Abrasion resistance             | very good                              | Corrosiveness of fumes | to IEC 60754-2   |
| Halogen                         | halogen-free, according to IEC 60754-2 | Impervious to smoke    | According to BS 6853 Appendix D, in accordance with EN 50268-2, According to IEC 61034-2 |
| Min. bending radius, repetitive | 6 * diameter                           | Resistance to oils     | in accordance with EN 50306-3  |

**Plug, left**

|                |                                    |
|----------------|------------------------------------|
| Connector left | M12 D-code – IP 67<br>straight pin |
|----------------|------------------------------------|

**Plug, right**

|                 |                                  |
|-----------------|----------------------------------|
| Connector right | M12 D-code – IP 67<br>angled pin |
|-----------------|----------------------------------|

**plug**

|                |                                    |                 |                                  |
|----------------|------------------------------------|-----------------|----------------------------------|
| Connector left | M12 D-code – IP 67<br>straight pin | Connector right | M12 D-code – IP 67<br>angled pin |
|----------------|------------------------------------|-----------------|----------------------------------|

**Classifications**

|             |             |             |             |
|-------------|-------------|-------------|-------------|
| ETIM 6.0    | EC002599    | ETIM 7.0    | EC002599    |
| ECLASS 9.0  | 27-06-03-08 | ECLASS 9.1  | 27-06-03-08 |
| ECLASS 10.0 | 27-06-03-08 | ECLASS 11.0 | 27-06-03-08 |

**Approvals**

Approvals



|                       |         |
|-----------------------|---------|
| ROHS                  | Conform |
| UL File Number Search | E316369 |

Creation date March 22, 2021 9:39:41 PM CET

Catalogue status 12.03.2021 / We reserve the right to make technical changes.

3

**Data sheet****IE-C5DB4RE0015MCSMCA-E****Weidmüller Interface GmbH & Co. KG**  
Klingenbergstraße 26  
D-32758 Detmold  
Germany[www.weidmueller.com](http://www.weidmueller.com)**Technical data****Downloads**

---

|                    |  |
|--------------------|--|
| Engineering Data   | <a href="#">WSCAD</a>  |
| User Documentation | <a href="#">MAN IE GUIDE DE</a><br><a href="#">MAN IE GUIDE EN</a> |

---

**Data sheet**

**IE-C5DB4RE0015MCSMCA-E**

**Weidmüller Interface GmbH & Co. KG**  
 Klingenbergstraße 26  
 D-32758 Detmold  
 Germany

[www.weidmueller.com](http://www.weidmueller.com)

**Drawings**

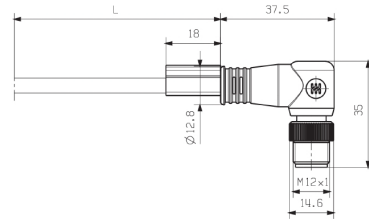
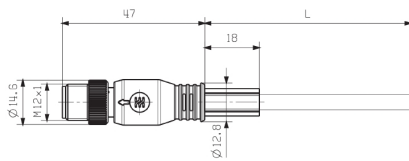

**Wiring diagram**

|     |        |     |
|-----|--------|-----|
| M12 |        | M12 |
| 1   | yellow | 1   |
| 2   | white  | 2   |
| 3   | orange | 3   |
| 4   | blue   | 4   |

**Detailed drawing**

