



SIGNALLING COLUMN SINGLE-FLASH LIGHT ELEMENT
BLUE,
24V DC

General technical details:		
product brand name		SIRIUS
Product component / fluorescent materials		Yes
Design of the optical signal		flash light
Type of voltage		DC
<ul style="list-style-type: none"> of operating voltage 		
Operating voltage		24
<ul style="list-style-type: none"> 1 / for DC / rated value 	V	
Reference code		P
<ul style="list-style-type: none"> according to DIN EN 61346-2 		
Mechanical design:		
Mounting type		Bayonet
External diameter / of the signal column element	mm	70
Lamp:		
Nature of fluorescent material		LED
Ambient conditions:		
Ambient temperature		-20 ... +50
<ul style="list-style-type: none"> during operating 	°C	

Protection class IP		IP65
Height	mm	65.5
Width	mm	70

Certificates/approvals:

General Product Approval	EMC	Declaration of Conformity	Shipping Approval
			
	UL	C-TICK	EG-Konf.
			
			DNV

Further information:

Information- and Downloadcenter (Catalogs, Brochures,...)

<http://www.siemens.com/industrial-controls/catalogs>

Industry Mall (Online ordering system)

<http://www.siemens.com/industrial-controls/mall>

Cax online generator:

<http://www.siemens.com/cax>

Service&Support (Manuals, Certificates, Characteristics, FAQs,...)

<http://support.automation.siemens.com/WW/view/en/8WD4420-0CF/all>

Image database (product images, 2D dimension drawings, 3D models, device circuit diagrams, ...)

http://www.automation.siemens.com/bilddb/cax_en.aspx?mlfb=8WD4420-0CF

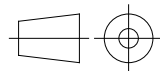
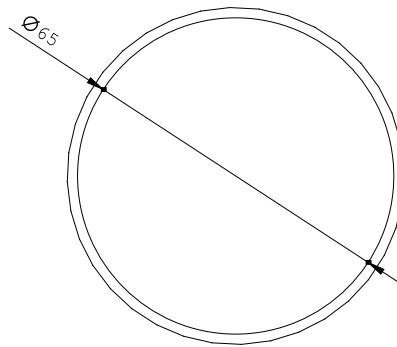
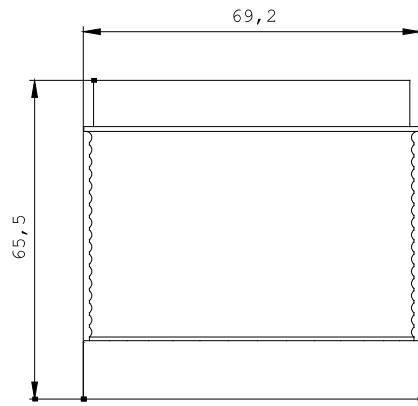

\W9.4444;
\W6.8333; 8WD44...-

last change:

Jun 16, 2014