



ENCLOSURE FOR SNAP-MOUNTED DEVICES COVER W.
1 FLAP SIZE 1,
1 X 12 MW COMPRISES 8HP1101+8HP5531+8HP1331

Similar to image

Technical data:

| | | |
|--|----|---------------|
| product brand name | | SIVACON |
| Mounting type | | flush mounted |
| Color | | grey |
| Width | mm | 307 |
| Height | mm | 153.5 |
| Depth | mm | 147 |
| RAL color number | | 7035 |
| Number of rows | | 1 |
| Product component / DIN mounting panel | | Yes |
| Number of width units | | 14 |
| Protection class IP | | IP65 |

Certificates/approvals:

General Product Approval

Declaration of Conformity

Test Certificates



GOST



EG-Konf.

[Special Test Certificate](#)

Further information:

Information- and Downloadcenter (Catalogs, Brochures,...)

<http://www.siemens.com/lowvoltage/catalogs>

Industry Mall (Online ordering system)

<https://eb.automation.siemens.com/mall/en/WW/Catalog/Product/8HP2521>

Service&Support (Manuals, Certificates, Characteristics, FAQs,...)

<http://support.automation.siemens.com/WW/view/en/8HP2521/all>

Image database (product images, 2D dimension drawings, 3D models, device circuit diagrams, ...)

http://www.automation.siemens.com/bilddb/cax_en.aspx?mlfb=8HP2521

CAX-Online-Generator

<http://www.siemens.com/cax>

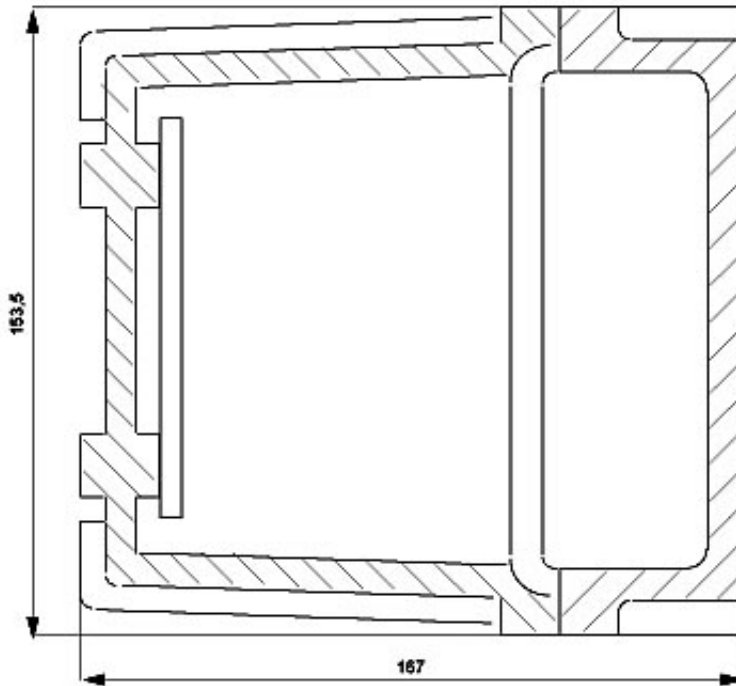

last change:

Jul 7, 2014