



ENCLOSURE FOR SNAP-MOUNTED DEVICES COVER
OPAQUE SIZE 1,
1 X 11 MW COMPRISES 8HP1101+8HP5531+8HP1201

Similar to image

Technical data:

product brand name		SIVACON
Mounting type		flush mounted
Color		grey
Width	mm	307
Height	mm	153.5
Depth	mm	147
RAL color number		7035
Number of rows		1
Product component / DIN mounting panel		Yes
Number of width units		14
Protection class IP		IP65

Certificates/approvals:

General Product
Approval

Declaration of
Conformity

Test Certificates



GOST



EG-Konf.

[Special Test
Certificate](#)

Further information:

Information- and Downloadcenter (Catalogs, Brochures,...)

<http://www.siemens.com/lowvoltage/catalogs>

Industry Mall (Online ordering system)

<https://eb.automation.siemens.com/mall/en/WW/Catalog/Product/8HP2511>

Service&Support (Manuals, Certificates, Characteristics, FAQs,...)

<http://support.automation.siemens.com/WW/view/en/8HP2511/all>

Image database (product images, 2D dimension drawings, 3D models, device circuit diagrams, ...)

http://www.automation.siemens.com/bilddb/cax_en.aspx?mlfb=8HP2511

CAX-Online-Generator

<http://www.siemens.com/cax>

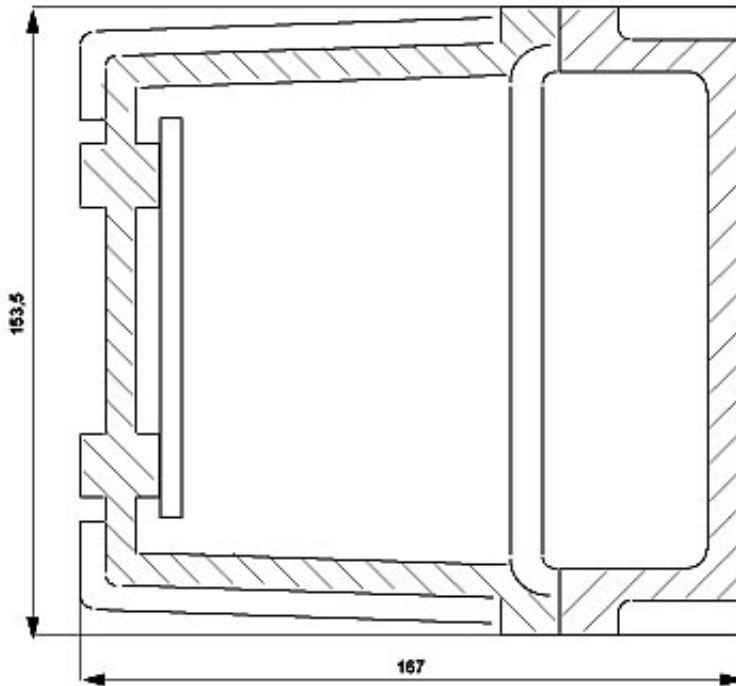

last change:

Jul 7, 2014