



EMPTY ENCLOSURE W. MOUNT. PLATE AND COVER, TRANSPARENT SIZE 1, MOUNTING DEPTH 147 MM COMPRISES 8HP1101+8HP1221+8HP6301

Similar to image

**Technical data:**

<b>Width</b>	mm	307
<b>Height</b>	mm	153.5
<b>Depth</b>	mm	147
<b>RAL color number</b>		7035
<b>Protection class IP</b>		IP65
<b>Design of the cap/top cover</b>		transparent
<b>Mounting depth</b>	mm	147
<b>Surface processing</b>		others
<b>Acceptability for application / for outside use</b>		No
<b>Suitability for interaction / lightning protection</b>		No
<b>Material / of the enclosure</b>		plastic
<b>Product component</b>		
• cable entry		Yes
• Mounting plate		Yes
<b>Product extension / optional / Sequence</b>		Yes

**Certificates/approvals:**

General Product Approval

Declaration of  
Conformity

Test Certificates



[Special Test  
Certificate](#)

**Further information:**

**Information- and Downloadcenter (Catalogs, Brochures,...)**

<http://www.siemens.com/lowvoltage/catalogs>

**Industry Mall (Online ordering system)**

<https://eb.automation.siemens.com/mall/en/WW/Catalog/Product/8HP2021>

**Service&Support (Manuals, Certificates, Characteristics, FAQs,...)**

<http://support.automation.siemens.com/WW/view/en/8HP2021/all>

**Image database (product images, 2D dimension drawings, 3D models, device circuit diagrams, ...)**

[http://www.automation.siemens.com/bilddb/cax\\_en.aspx?mlfb=8HP2021](http://www.automation.siemens.com/bilddb/cax_en.aspx?mlfb=8HP2021)

**CAX-Online-Generator**

<http://www.siemens.com/cax>

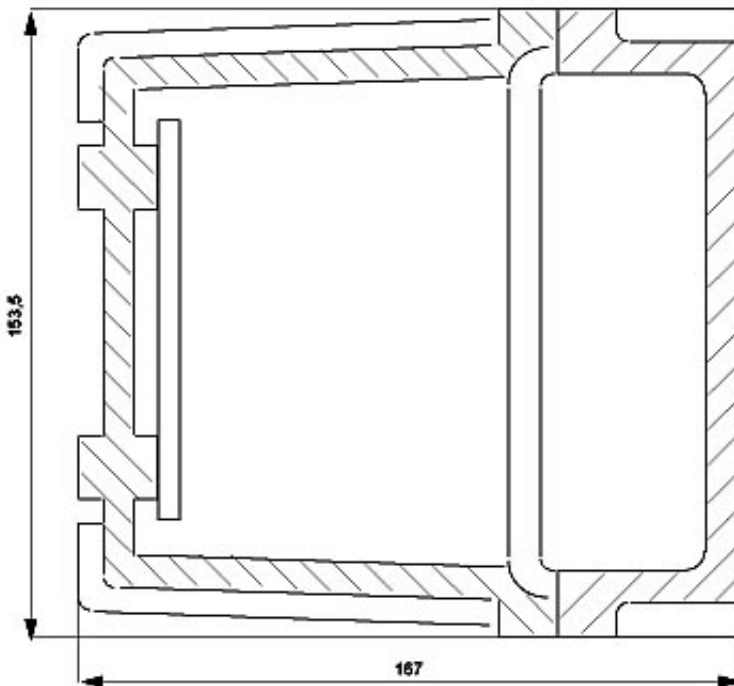

last change:

Oct 8, 2012