



CONTACTOR,  
55KW/400V/AC-3 AC(40...60HZ)/DC OPERATION UC  
200...220V AUXIL. CONTACTS 2NO+2NC 3-POLE,  
SIZE S6 WITH BOX TERMINALS CONVENTIONAL  
OPERATING MECHAN. SCREW TERMINAL

### General technical data:

<b>product brand name</b>		SIRIUS
<b>Size of the contactor</b>		S6
<b>Protection class IP / on the front</b>		IP00
<b>Degree of pollution</b>		3
<b>Installation altitude / at a height over sea level / maximum</b>	m	2,000
<b>Ambient temperature / during operating</b>	°C	-25 ... +60
<b>Mechanical operating cycles as operating time</b>		
<ul style="list-style-type: none"> <li>• of the contactor / typical</li> <li>• of the contactor with added auxiliary switch block / typical</li> <li>• of the contactor with added electronics-compatible auxiliary switch block / typical</li> </ul>		<p>10,000,000</p> <p>10,000,000</p> <p>5,000,000</p>

### Main circuit:

<b>Number of NC contacts / for main contacts</b>		0
<b>Number of NO contacts / for main contacts</b>		3
<b>Operating current</b>		
<ul style="list-style-type: none"> <li>• at AC-1 / at 400 V <ul style="list-style-type: none"> <li>• at 40 °C ambient temperature / rated value</li> </ul> </li> <li>• at AC-3 / at 400 V / rated value</li> <li>• at AC-4 / at 400 V / rated value</li> </ul>	<p>A</p> <p>A</p> <p>A</p>	<p>160</p> <p>115</p> <p>97</p>

• with 1 current path / at DC-1		
• at 24 V / rated value	A	160
• at 110 V / rated value	A	18
• with 2 current paths in series / at DC-1		
• at 24 V / rated value	A	160
• at 110 V / rated value	A	160
• with 3 current paths in series / at DC-1		
• at 24 V / rated value	A	160
• at 110 V / rated value	A	160
• with 1 current path / at DC-3 / at DC-5		
• at 24 V / rated value	A	160
• at 110 V / rated value	A	2.5
• with 2 current paths in series / at DC-3 / at DC-5		
• at 24 V / rated value	A	160
• at 110 V / rated value	A	160
• with 3 current paths in series / at DC-3 / at DC-5		
• at 24 V / rated value	A	160
• at 110 V / rated value	A	160
<b>Service power</b>		
• at AC-2 / at 400 V / rated value	kW	64
• at AC-3 / at 400 V / rated value	kW	64
• at AC-4 / at 400 V / rated value	W	55,000

#### Control circuit:

<b>Design of the surge suppressor</b>		with varistor
<b>Voltage type / of control feed voltage</b>		AC/DC
<b>Operating range factor control supply voltage rated value / of the magnet coil</b>		
• at 50 Hz		
• for AC		0.8 ... 1.1
• at 60 Hz		
• for AC		0.8 ... 1.1
• for DC		0.8 ... 1.1
<b>Apparent pull-in power / of the solenoid / for AC</b>	V·A	300
<b>Apparent holding power / of the solenoid / for AC</b>	V·A	5.8
<b>Inductive power factor / with the pull-in power of the coil</b>		0.9
<b>Inductive power factor / with the pull-in power of the coil</b>		0.8
<b>Pull-in power / of the solenoid / for DC</b>	W	360
<b>Holding power / of the solenoid / for DC</b>	W	5.2

#### Auxiliary circuit:

<b>Number of NC contacts / for auxiliary contacts / instantaneous switching</b>		2
<b>Number of NO contacts / for auxiliary contacts / instantaneous switching</b>		2

#### Short-circuit:

##### Design of the fuse link

- for short-circuit protection of the auxiliary switch / required
- for short-circuit protection of the main circuit
  - with type of assignment 1 / required
  - at type of coordination 2 / required

fuse gL/gG: 10 A  
  
fuse gL/gG: 355 A  
  
fuse gL/gG: 315 A

#### Installation/mounting/dimensions:

<b>Mounting type</b>		screw fixing
<b>series installation</b>		Yes
<b>Width</b>	mm	120
<b>Height</b>	mm	172
<b>Depth</b>	mm	170
<b>Distance, to be maintained, to earthed part / sideways</b>	mm	10

#### Connection type:

##### Design of the electrical connection

- for main current circuit
- for auxiliary and control current circuit

screw-type terminals  
  
screw-type terminals

##### Type of the connectable conductor cross-section

- for main contacts
  - stranded
  - finely stranded
    - with conductor end processing
    - without conductor final cutting
- for AWG conductors / for main contacts
- for auxiliary contacts
  - solid
  - finely stranded
    - with conductor end processing
- for AWG conductors / for auxiliary contacts

max. 2x 70 mm<sup>2</sup>  
  
max. 1x 50, 1x 70 mm<sup>2</sup>  
max. 1x 50, 1x 70 mm<sup>2</sup>  
  
2x 1/0  
  
2x (0.5 ... 1.5 mm<sup>2</sup>), 2x (0.75 ... 2.5 mm<sup>2</sup>), max. 2x (0.75 ... 4 mm<sup>2</sup>)  
  
2x (0.5 ... 1.5 mm<sup>2</sup>), 2x (0.75 ... 2.5 mm<sup>2</sup>)  
  
2x (20 ... 16), 2x (18 ... 14), 1x 12

#### Certificates/approvals:

## General Product Approval

Functional Safety /  
Safety of  
Machinery



CCC



CSA



KETI



UL

[Type Examination](#)

## Declaration of Conformity

## Test Certificates



EG-Konf.

[Special Test  
Certificate](#)

[Type Test  
Certificates/Test  
Report](#)

## Shipping Approval



ABS



DNV



GL



RMRS

## other

[Confirmation](#)

[other](#)

[Environmental  
Confirmations](#)

## Further information:

### Information- and Downloadcenter (Catalogs, Brochures,...)

<http://www.siemens.com/industrial-controls/catalogs>

### Industry Mall (Online ordering system)

<http://www.siemens.com/industrial-controls/mall>

### Cax online generator:

<http://www.siemens.com/cax>

### Service&Support (Manuals, Certificates, Characteristics, FAQs,...)

<http://support.automation.siemens.com/WW/view/en/3RT1054-1AM36/all>

### Image database (product images, 2D dimension drawings, 3D models, device circuit diagrams, ...)

[http://www.automation.siemens.com/bilddb/cax\\_en.aspx?mlfb=3RT1054-1AM36](http://www.automation.siemens.com/bilddb/cax_en.aspx?mlfb=3RT1054-1AM36)

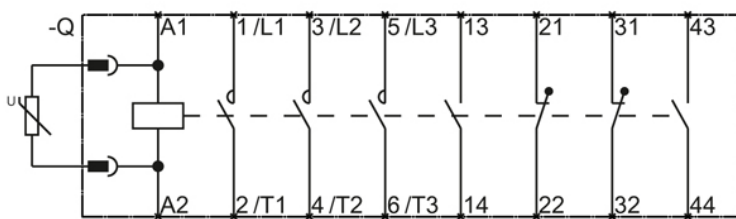
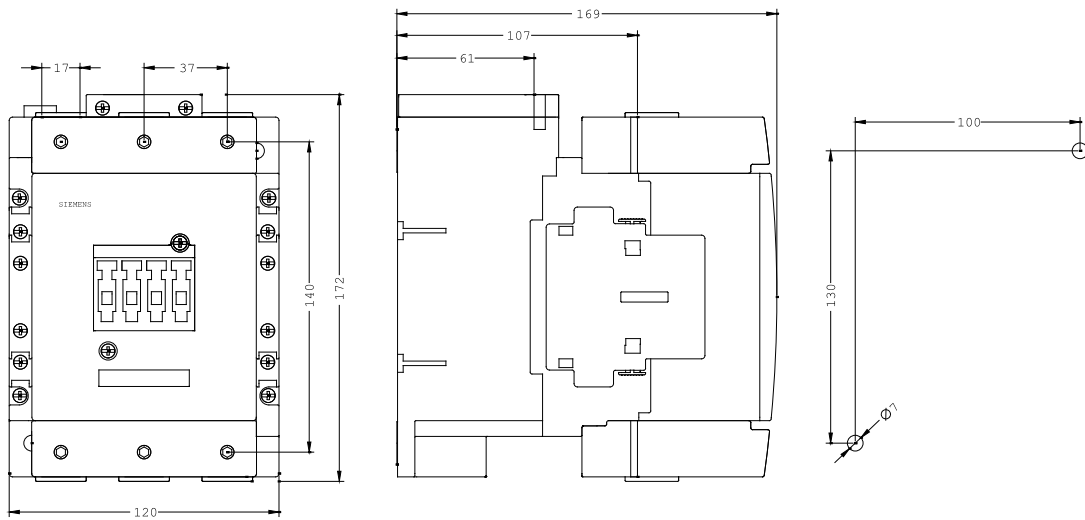

last change:

Jul 28, 2014