



CONTACTOR RELAY, 2 NO + 2 NC,  
AC 100 V 50/100...110V, 60HZ,  
SCREW-TYPE CONNECT., MOD. S00

### General technical data:

product brand name		SIRIUS
Product designation		contactor relay
Size of the contactor		S00
Protection class IP / on the front		IP20
Degree of pollution		3
Insulation voltage / with degree of pollution 3 / rated value	V	690
Installation altitude / at a height over sea level / maximum	m	2,000
Ambient temperature		
• during transport	°C	-55 ... +80
• during storage	°C	-55 ... +80
• during operating	°C	-25 ... +60
Contact reliability		one incorrect switching operation of 100 million switching operations (17 V, 1 mA)
Resistance against shock		10g / 5 ms and 5g / 10 ms
Impulse voltage resistance / rated value	kV	6
Reference code		
• according to DIN EN 61346-2		K
• according to DIN 40719 extended according to IEC 204-2 / according to IEC 750		K
• according to DIN EN 81346-2		K

<b>Mechanical operating cycles as operating time</b>		
• of the contactor / typical		30,000,000
• of the contactor with added auxiliary switch block / typical		10,000,000
• of the contactor with added electronics-compatible auxiliary switch block / typical		5,000,000

Control circuit/ Control:		
<b>Voltage type / of control feed voltage</b>		AC
<b>Control supply voltage frequency</b>		
• 1 / rated value	Hz	50
• 2 / rated value	Hz	60
<b>Control supply voltage</b>		
• at 50 Hz / at AC / rated value	V	100
• at 60 Hz / at AC / rated value	V	110
• at 60 Hz / at AC		
• rated value	V	100 ... 110
<b>Operating range factor control supply voltage rated value / of the magnet coil</b>		
• at 50 Hz		
• for AC		0.8 ... 1.1
• at 60 Hz		
• for AC		0.85 ... 1.1
<b>Apparent pull-in power / of the solenoid / for AC</b>	V·A	27
<b>Apparent holding power / of the solenoid / for AC</b>	V·A	4.6
<b>Inductive power factor</b>		
• with the pull-in power of the coil		0.8
• with the pull-in power of the coil		0.27

Auxiliary circuit:		
<b>Product extension / auxiliary switch</b>		Yes
<b>Identification number and letter for switching elements</b>		22 E
<b>Contact reliability / of the auxiliary contacts</b>		1 faulty switching per 100 million (17 V, 1 mA)
<b>Number of NC contacts / for auxiliary contacts</b>		2
• delayed switching		0
• instantaneous switching		2
• asynchronous switching		0
• lagging switching		0
<b>Number of NO contacts / for auxiliary contacts</b>		2
• instantaneous switching		2
• delayed switching		0
• asynchronous switching		0

• leading switching		0
<b>Number of changeover contacts</b>		
• for auxiliary contacts		0
• of the auxiliary contacts / instantaneous switching		0
<b>Operating current</b>		
• at AC-12 / maximum	A	10
• at AC-15		
• at 230 V / rated value	A	6
• at 400 V / rated value	A	3
• at 500 V / rated value	A	2
• at 690 V / rated value	A	1
<b>Operating current / with 1 current path</b>		
• at DC-12		
• at 24 V / rated value	A	10
• at 110 V / rated value	A	3
• at 220 V / rated value	A	1
• at DC-13		
• at 24 V / rated value	A	10
• at 110 V / rated value	A	1
• at 220 V / rated value	A	0.27

#### Short-circuit:

**Design of the fuse link / for short-circuit protection of the auxiliary switch / required**

fuse gL/gG: 10 A

#### Installation/ mounting/ dimensions:

<b>mounting position</b>		+/-180° rotation possible on vertical mounting surface; can be tilted forward and backward by +/- 22.5° on vertical mounting surface
<b>Mounting type</b>		screw and snap-on mounting
<b>Width</b>	mm	45
<b>Height</b>	mm	57.5
<b>Depth</b>	mm	72
<b>Distance, to be maintained, to the ranks assembly / sideways</b>	mm	0

#### Connections/ terminals:

<b>Design of the electrical connection / for auxiliary and control current circuit</b>		screw-type terminals
<b>Type of the connectable conductor cross-section</b>		
• for auxiliary contacts		
• solid		2x (0.5 ... 1.5 mm <sup>2</sup> ), 2x (0.75 ... 2.5 mm <sup>2</sup> ), 2x 4 mm <sup>2</sup>
• finely stranded		

- with conductor end processing
- for AWG conductors / for auxiliary contacts

2x (0.5 ... 1.5 mm<sup>2</sup>), 2x (0.75 ... 2.5 mm<sup>2</sup>)  
 2x (20 ... 16), 2x (18 ... 14), 1x 12

## Certificates/ approvals:

### Verification of suitability

CSA / UL / CCC / GL / LRS / BV / DNV / RMRS / RINA

### General Product Approval

Functional Safety /  
Safety of  
Machinery

Declaration of  
Conformity



[Type Examination](#)



### Test Certificates

[Special Test  
Certificate](#)

[Type Test  
Certificates/Test  
Report](#)

### Shipping Approval



### Shipping Approval

other



[other](#)

[Environmental  
Confirmations](#)

## Safety related data:

### Proportion of dangerous failures

- with high demand rate / according to SN 31920
- with low demand rate / according to SN 31920

% 75  
 % 40

### Protection against electrical shock

finger-safe

### T1 value / for proof test interval or service life / according to IEC 61508

a 20

### B10 value / with high demand rate

- according to SN 31920
- note

1,000,000  
 With 0.3 x le

## Further information:

### Information- and Downloadcenter (Catalogs, Brochures,...)

<http://www.siemens.com/industrial-controls/catalogs>

### Industry Mall (Online ordering system)

<https://mall.industry.siemens.com/>

### Cax online generator

<http://www.siemens.com/cax>

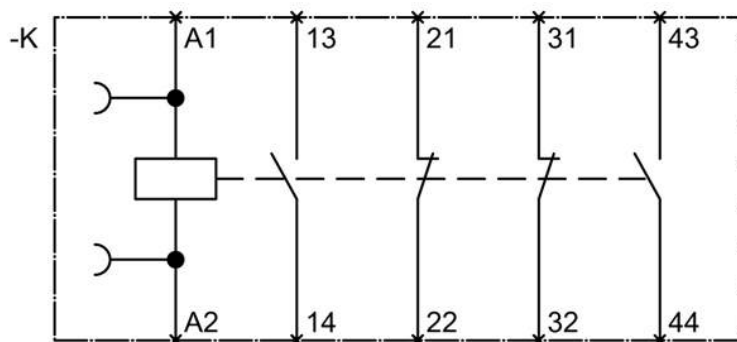
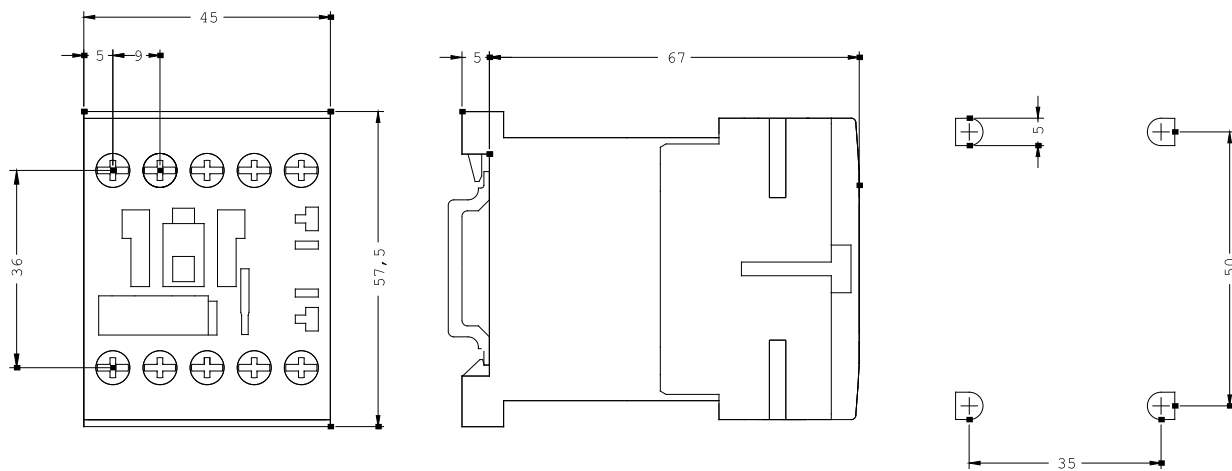

last change:

Jul 21, 2014