

REVERSING CONTACTOR COMBINATION AC-3 3KW/400 V,  
3-POLE, SIZES00 SCREW CONNECTION,  
DC 220 V, EL. AND MECH. LOCKING DEVICE

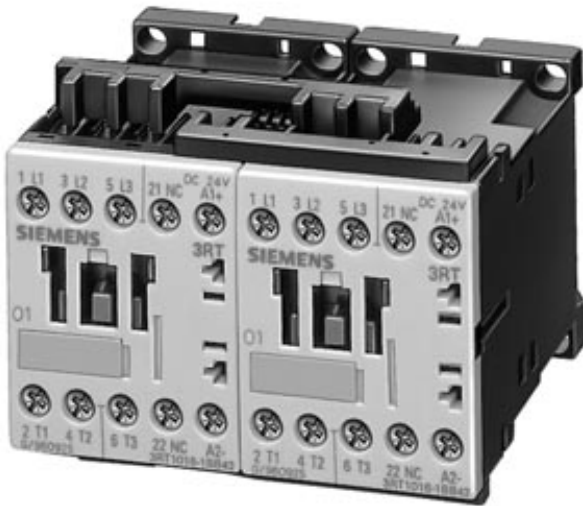

### General technical data:

<b>Product function</b>		reversing contactor
<b>Size of the contactor</b>		S00
<b>Width</b>	mm	90
<b>Height</b>	mm	67
<b>Depth</b>	mm	72
<b>Reference code</b>		
<ul style="list-style-type: none"> <li>• according to DIN EN 61346-2</li> <li>• according to DIN 40719 extended according to IEC 204-2 / according to IEC 750</li> </ul>		Q K

### Control circuit/ Control:

<b>Voltage type / of control feed voltage</b>		DC
<b>Control supply voltage / 1</b>		
<ul style="list-style-type: none"> <li>• for DC</li> <li>• rated value</li> </ul>	V	220

### Main circuit:

<b>Operating current / at AC-3 / at 400 V</b>		
<ul style="list-style-type: none"> <li>• rated value</li> </ul>	A	7
<b>Service power / at AC-3 / at 400 V</b>		

• rated value

kW 3

#### Auxiliary circuit:

Number of NC contacts / for auxiliary contacts / per direction of rotation

0

Number of NO contacts / for auxiliary contacts / per direction of rotation

0

#### Connections/ terminals:

Design of the electrical connection / for main current circuit

screw-type terminals

Mounting type

screw and snap-on mounting onto 35 mm standard mounting rail according to DIN EN 50022

#### Ambient conditions:

Ambient temperature

• during operating

°C

-25 ... +60

Protection class IP / on the front

IP20

#### Certificates/ approvals:

General Product Approval

Declaration of  
Conformity

Test Certificates



[Special Test Certificate](#)

#### Shipping Approval



Shipping Approval

other



[other](#)

[Environmental Confirmations](#)

#### Further information:

Information- and Downloadcenter (Catalogs, Brochures,...)

<http://www.siemens.com/industrial-controls/catalogs>

Industry Mall (Online ordering system)

<http://www.siemens.com/industrial-controls/mall>

Cax online generator

<http://www.siemens.com/cax>

Service&Support (Manuals, Certificates, Characteristics, FAQs,...)

<http://support.automation.siemens.com/WW/view/en/3RA1315-8XB30-1BM4/all>

Image database (product images, 2D dimension drawings, 3D models, device circuit diagrams, ...)

[http://www.automation.siemens.com/bilddb/cax\\_en.aspx?mlfb=3RA1315-8XB30-1BM4](http://www.automation.siemens.com/bilddb/cax_en.aspx?mlfb=3RA1315-8XB30-1BM4)

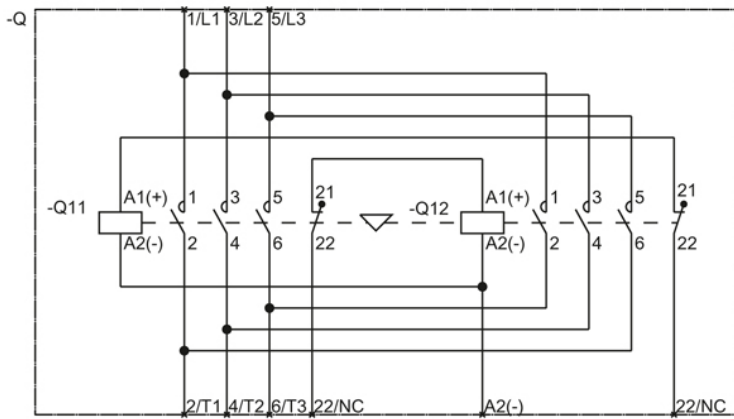
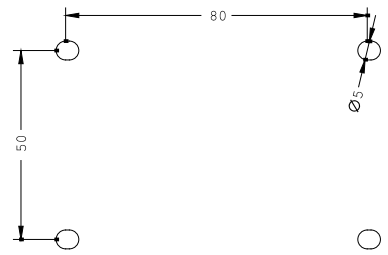
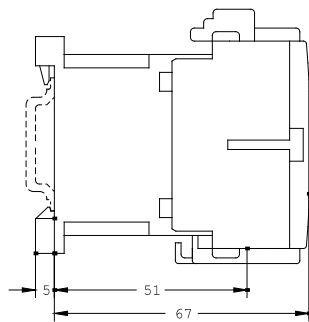
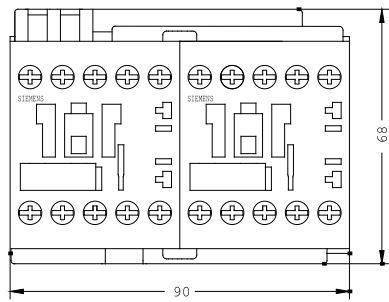

last change:

Jul 28, 2014