

IZ5047

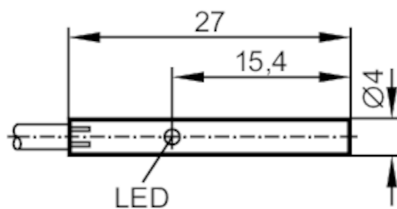

Inductive sensor

IZB31,5-BPKG/2M PVC



Electrical data

Operating voltage	[V]	10...30 DC
Current consumption	[mA]	10; (24 V)
Reverse polarity protection		yes

Outputs

Electrical design		PNP
Output function		normally open
Max. voltage drop switching output DC	[V]	3
Permanent current rating of switching output DC	[mA]	100
Switching frequency DC	[Hz]	1800
Short-circuit protection		yes
Type of short-circuit protection		pulsed
Overload protection		yes

Detection zone

Sensing range	[mm]	1.5
Real sensing range Sr	[mm]	1.5 ± 10 %
Operating distance	[mm]	0...1.2

Accuracy / deviations

Correction factor		steel: 1 / stainless steel: 0.7 / brass: 0.5 / aluminium: 0.4 / copper: 0.3
Hysteresis	[% of Sr]	< 15
Switch point drift	[% of Sr]	-10...10

Operating conditions

Ambient temperature	[°C]	-25...80
Protection		IP 67

Tests / approvals

EMC		EN 60947-5-2	
		EN 55011	class B
MTTF	[years]		835
UL approval		Ta	0...40 °C
		voltage supply	Class 2
		File number UL	E174191

IZ5047



Inductive sensor

IZB31,5-BPKG/2M PVC

Mechanical data	
Weight [g]	59
Housing	cylindrical
Mounting	non-flush mountable
Dimensions [mm]	Ø 4 / L = 27
Materials	housing: stainless steel; sensing face: POM

Displays / operating elements		
Display	switching status	4 x 90° LED, red

Accessories	
Accessories (supplied)	Mounting clamps: 1

Remarks	
Pack quantity	1 pcs.

Electrical connection	
Cable: 2 m, PVC; 3 x 0.14 mm ²	

Connection

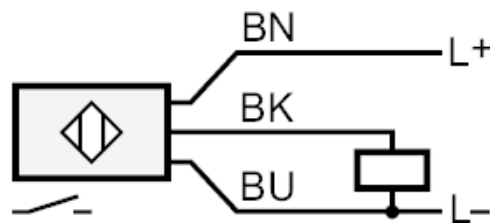

Core colours :

BK =	black
BN =	brown
BU =	blue

IZ5047



Inductive sensor

IZB31,5-BPKG/2M PVC

Diagrams and graphs

Installation

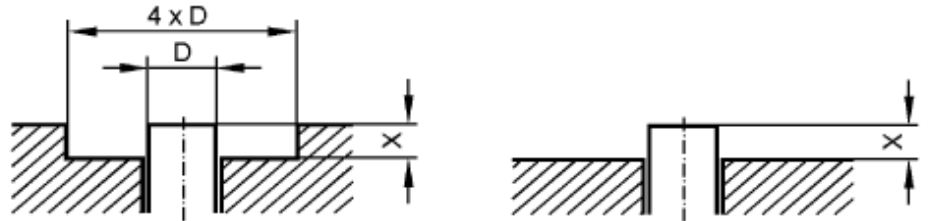

If S_r varies by $< 10\%$ the following free space must be maintained ferromagnetic materials $X > 1.5\text{ mm}$ other metals $X > 3.0\text{ mm}$