

# E23000

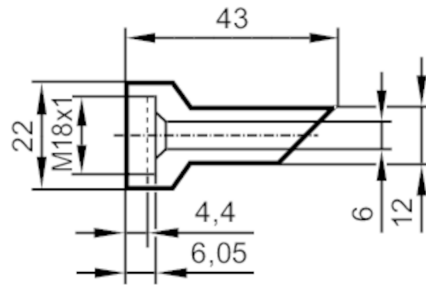

## Sound tube

SOUND TUBE M18



### Mechanical data

Weight	[g]	8
Materials		POM
Sealing		Gasket

### Remarks

Pack quantity		1 pcs.
---------------	--	--------

### Diagrams and graphs

response curve

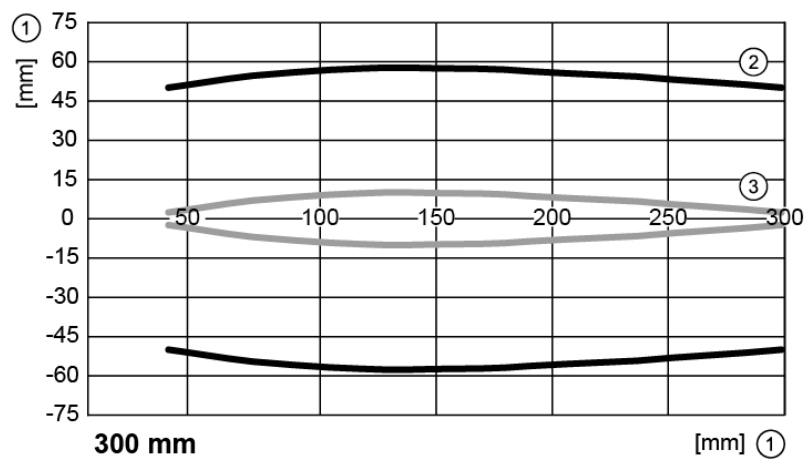

response curve

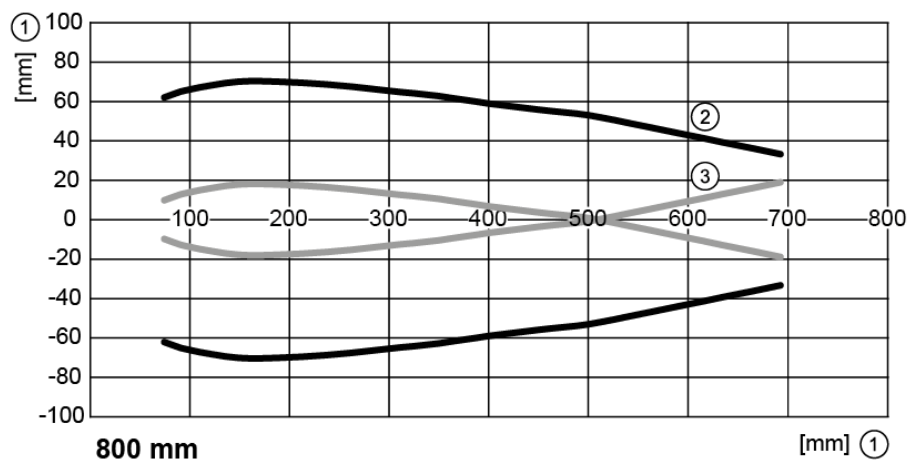

# E23000



## Sound tube

SOUND TUBE M18

response curve

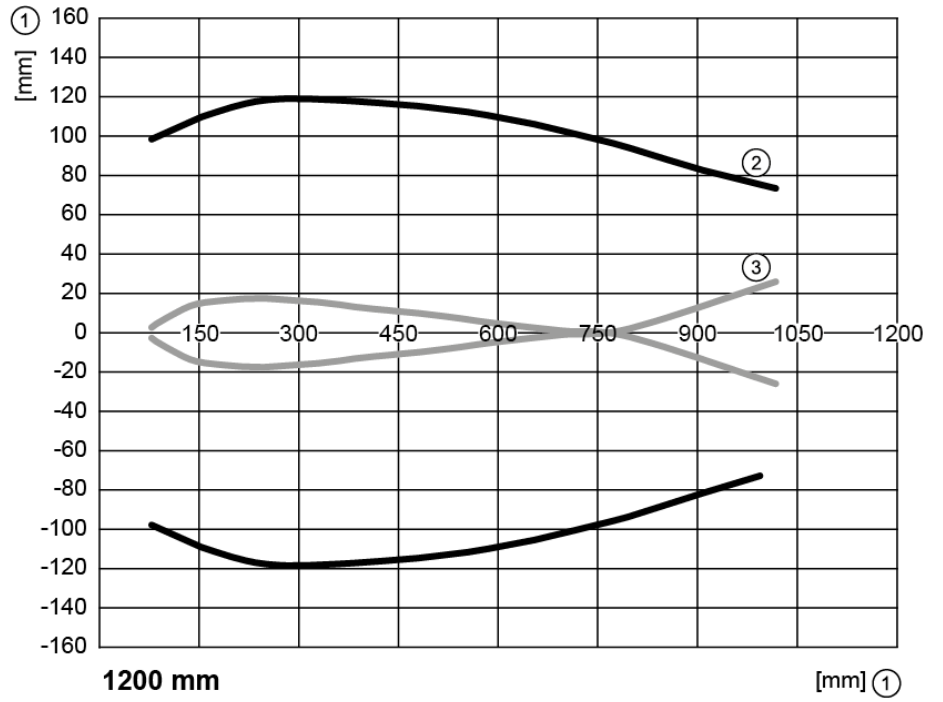

response curve

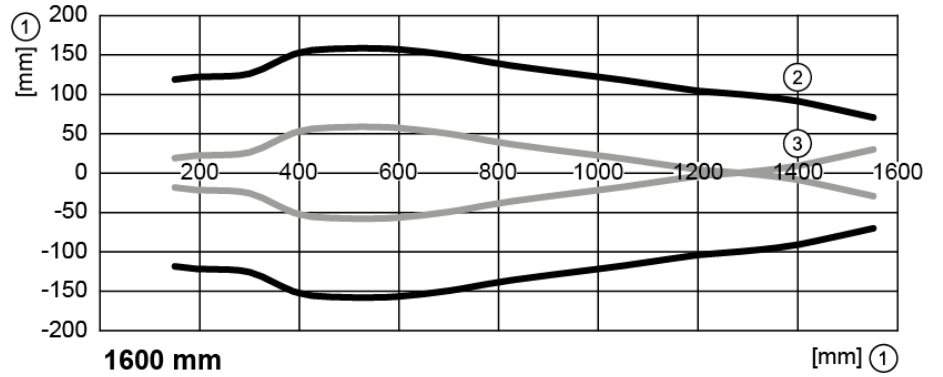

response curve

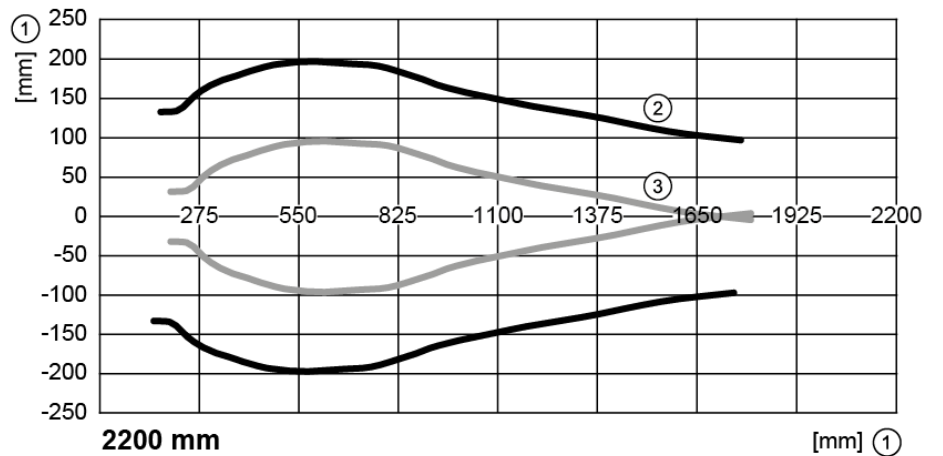

# E23000

## Sound tube

SOUND TUBE M18

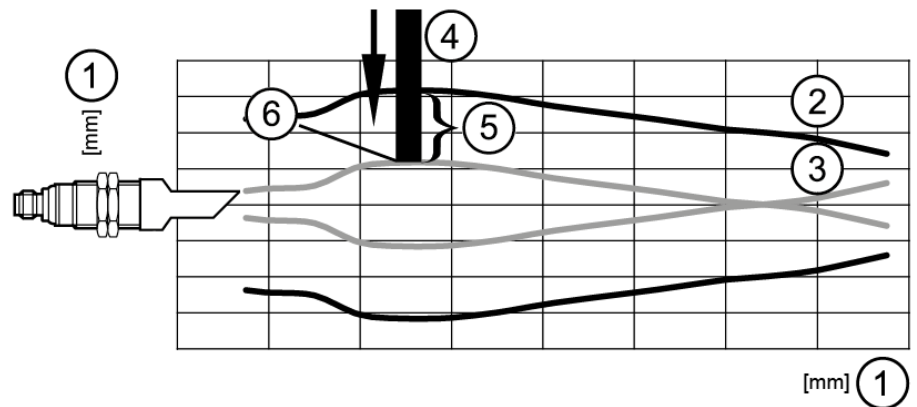

- 1 distance
- 2 Detection zone
- 3 switch-on/switch-off graph
- 4 Target
- 5 50 % of the target in the detection zone
- 6 switch point