

**Modlink MSDD-set: Frame 4000-68112-0000000,**  
insert 4000-68000-0010000

[Link to Product](#)

Illustration

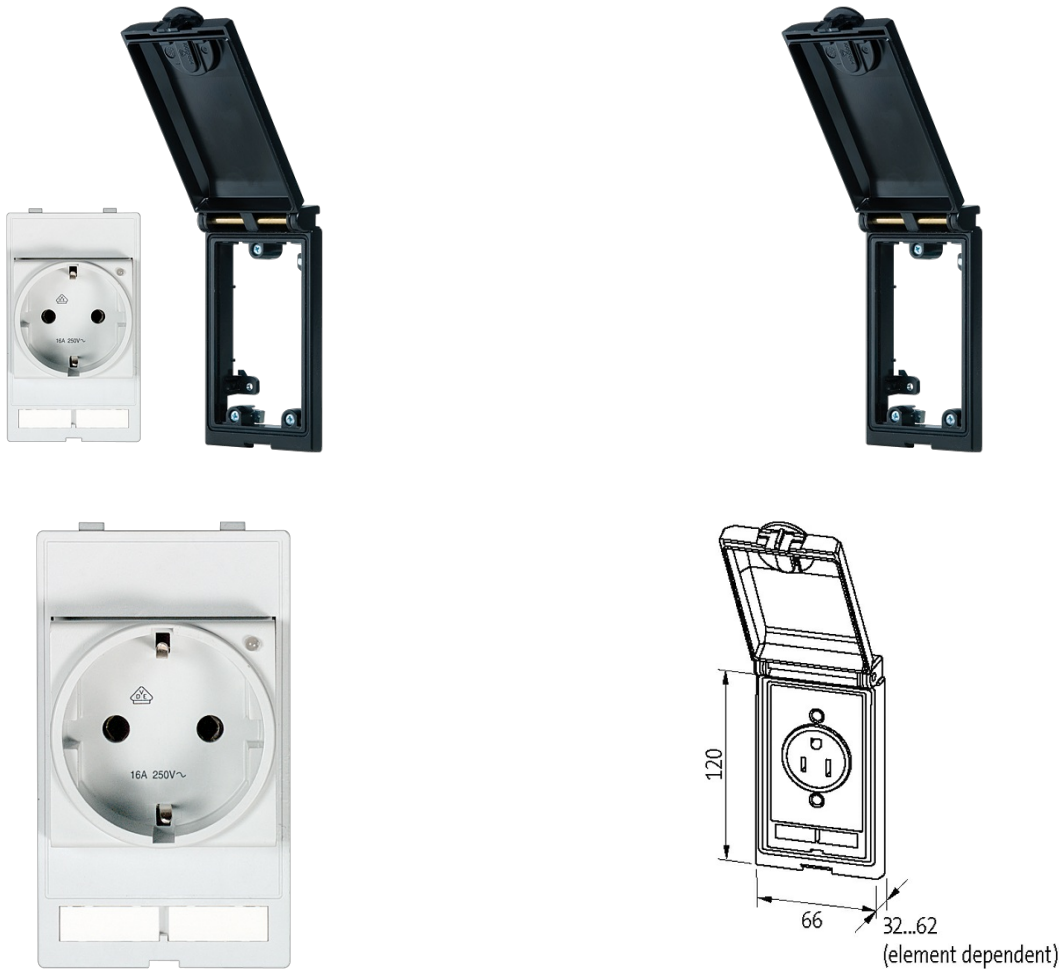

Product may differ from Image

Frame	
suitable for mounting with wall thickness	1...5 mm
Protection	IP65
Housing	Zinc die-casting, KTL coated
Temperature range	-10...+60 °C (storage temperature -25...+60 °C)
Germany (VDE)	
Operating voltage	250 V AC
Operating current	16 A
No. of poles	2 + PE
Connection	Screw terminals: max. 2× 6 mm² (AWG 10)
LED display	yellow
Commercial data	
country of origin	BE
customs tariff number	85366990
EAN	4048879036634

eClass	27189217
Packaging unit	1